

GT21-04RATT-40

ATTACHMENT (for 4.3") (for GOT2000 Series) User's Manual



Manual No.	JY997D69501C
Date of issue	Aug. 2022

This manual explains the names, outline dimensions and specifications of each part of the GT21 attachment (hereinafter, attachment). Refer to the GOT2000 Series for the GOT2000 (hereinafter, GOT) Safety Precautions.

Before use, read this manual and manuals of relevant products fully to acquire proficiency in handling and operating the product. Make sure to learn all the product information, safety information, and precautions. And, store this manual in a safe place so that you can take it out and read it whenever necessary. Always forward it to the end user.

Registration
The company name and the product name to be described in this manual are the registered trademarks or trademarks of each company.

Effective: Aug. 2022
Specifications are subject to change without notice.
© 2016 MITSUBISHI ELECTRIC CORPORATION

Safety Precaution (Read these precautions before using.)

In this manual, the safety precautions are ranked as **WARNING** and **CAUTION**.

WARNING	Indicates that incorrect handling may cause hazardous conditions, resulting in death or severe injury.
CAUTION	Indicates that incorrect handling may cause hazardous conditions, resulting in medium or slight personal injury or physical damage.

Depending on circumstances, procedures indicated by **CAUTION** may also be linked to serious results. In any case, it is important to follow the directions for usage.

MOUNTING PRECAUTIONS CAUTION
<ul style="list-style-type: none"> When mounting the attachment onto the mounting panel face, set the attachment on the front surface of the mounting panel and tighten the clamp screws to within the specified torque range (0.20 N•m to 0.25 N•m) with a screwdriver. If the mounting screws are not tightened properly, the attachment could fall, fail or malfunction. If the mounting screws are too tight, the screw or unit could break and result in dropping, failure or malfunction. Periodically confirm that the mounting screws are not loose.

PRECAUTIONS FOR USE CAUTION
<ul style="list-style-type: none"> Do not use in an environment subject to vibration or impact. Confirm the strength of the mounting panel. It must have sufficient strength to withstand the weight of the GOT and cables, and to withstand the force applied during mounting and removal.

DISPOSAL PRECAUTIONS CAUTION
<ul style="list-style-type: none"> When disposing of the product, handle it as industrial waste.

Related Manuals

The following manuals are relevant to this product. When these manuals are required please consult with our local distributor.

Manual name	Manual Number (Model Code)	Contents
GOT2000 Series User's Manual (Hardware)	SH-081194ENG (1D7MJ5)	Describes the GOT2000 Series hardware relevant content such as part names, external dimensions, mounting, wiring, specifications, and introduction to option devices. (sold separately)

Referenced Standard: GB/T15969.2
(Requirement of Chinese standardized law)

1. Overview

This attachment is a fixture used when replacing the GT104□type GOT with the GT2104-RTBD type GOT.

1.1 Bundled Items

Bundled item	Quantity
Clamp screw (M4x10)	2
ATTACHMENT (for 4.3") (for GOT2000 Series) User's Manual (This manual)	1

2. External dimensions and weight

2.1 External Dimensions

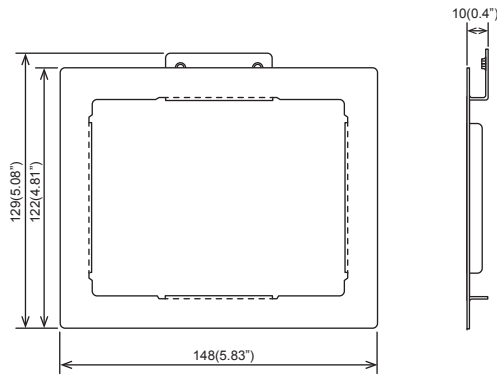

Unit: mm(inch)

2.2 Weight

0.1kg

3. Specifications

3.1 General specifications

The general specifications are the same as the GOT unit. Refer to the following manual.

→ **GOT2000 Series User's Manual (Hardware)**

- Precautions for mounting attachment
 - The attachment can be used when the mounting panel thickness is 2 to 3 mm. If the mounting panel thickness exceeds 3 mm, the GOT cannot be replaced using the attachment.
 - After replacement, the GOT with the attachment is not IP67F-rated (waterproof and dustproof).

4. Installation Procedure

- The model is indicated on the attachment. The upper part of the attachment has the model indication.

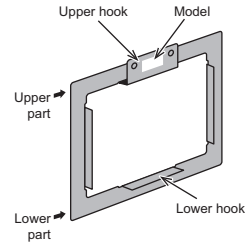

- Hook the upper hook onto the top side of the panel cut on the control panel. Refer to the figure shown in 1).

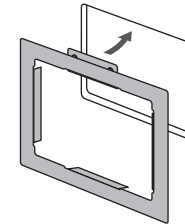

- While lifting the attachment upward, contact the lower hook onto the lower side of the panel cut on the control panel.

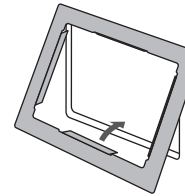

- Fix the attachment to the control panel with two clamp screws in the torque range of 0.20 to 0.25 N•m.

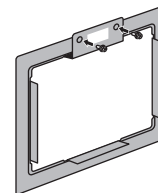

- Place the GOT into the attachment from the front, and fix it by tightening the mounting screws included with the GOT in the torque range of 0.20 to 0.25 N•m.

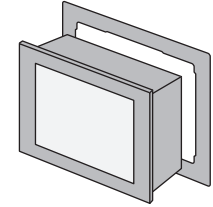

- Precautions for tightening lower bracket
 - As shown below, tighten the attachment and control panel together with the lower bracket.

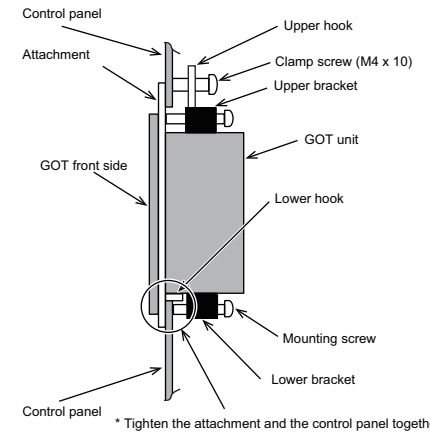

* Tighten the attachment and the control panel together.

This manual confers no industrial property rights or any rights of any other kind, nor does it confer any patent licenses. Mitsubishi Electric Corporation cannot be held responsible for any problems involving industrial property rights which may occur as a result of using the contents noted in this manual.

Warranty
Exclusion of loss in opportunity and secondary loss from warranty liability
Regardless of the gratis warranty term, Mitsubishi shall not be liable for compensation to:
 (1) Damages caused by any cause found not to be the responsibility of Mitsubishi.
 (2) Loss in opportunity, lost profits incurred to the user by Failures of Mitsubishi products.
 (3) Special damages and secondary damages whether foreseeable or not, compensation for accidents, and compensation for damages to products other than Mitsubishi products.
 (4) Replacement by the user, maintenance of on-site equipment, start-up test run and other tasks.

For safe use

- This product has been manufactured as a general-purpose part for general industries, and has not been designed or manufactured to be incorporated in a device or system used in purposes related to human life.
- Before using the product for special purposes such as nuclear power, electric power, aerospace, medicine or passenger movement vehicles, consult with Mitsubishi Electric.
- This product has been manufactured under strict quality control. However when installing the product where major accidents or losses could occur if the product fails, install appropriate backup or failsafe functions in the system.