

TECHNICAL BULLETIN

[Issue No.] FA-A-0131

[Page] 1/2

[Title] Change in a temperature control module, the Q64TCTTBW

[Date of Issue] February 2012

[Relevant Models] Q64TCTTBW

Thank you for your continued support of Mitsubishi programmable controllers, MELSEC-Q series.

To improve environment resistance, a MELSEC-Q series temperature control module, the Q64TCTTBW will be partly changed.

1. Change details

The change will be made to the encircled parts in the figure below.

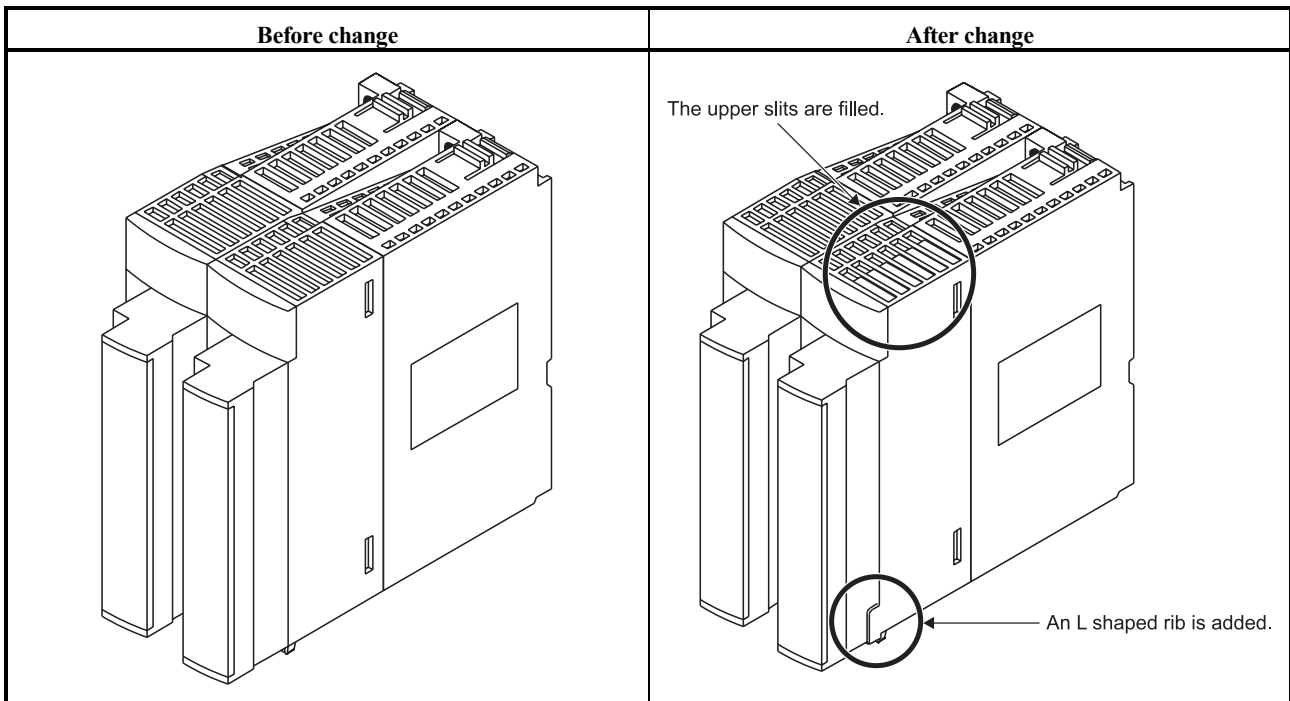

2. A relevant model and the versions

The change will be made to the modules with the following versions.

Series	Model	Module name	Version	
MELSEC-Q	Q64TCTTBW	Temperature control module	Serial number (first six digits)	140316 or later

TECHNICAL BULLETIN

[Issue No.] FA-A-0131

[Page] 2/2

[Title] Change in a temperature control module, the Q64TCTTBW

[Date of Issue] February 2012

[Relevant Models] Q64TCTTBW

3. How to check the version

Check the serial number (first six digits) on the rating plate located on the side of the module.

