

**Subject:** The change of fore arm part externals of RV-13F(L)

**Applicable to:** RV-13F(L) series

Thank you for your continued support of Mitsubishi industrial robot MELFA series.  
This Technical News explains the change in the design of the fore arm part in RV-13F(L).

## **1. Model and part**

- (1) Model: RV-13F(L) series
- (2) Part: Fore arm part

## **2. Details of the Design Change**

The design of the fore arm part is changed.

By this change, there is no influence of the function and performance on a robot.

Change before and after the robot will mix from the description time of 4 Section.

Please refer to the next page about details of the change contents.

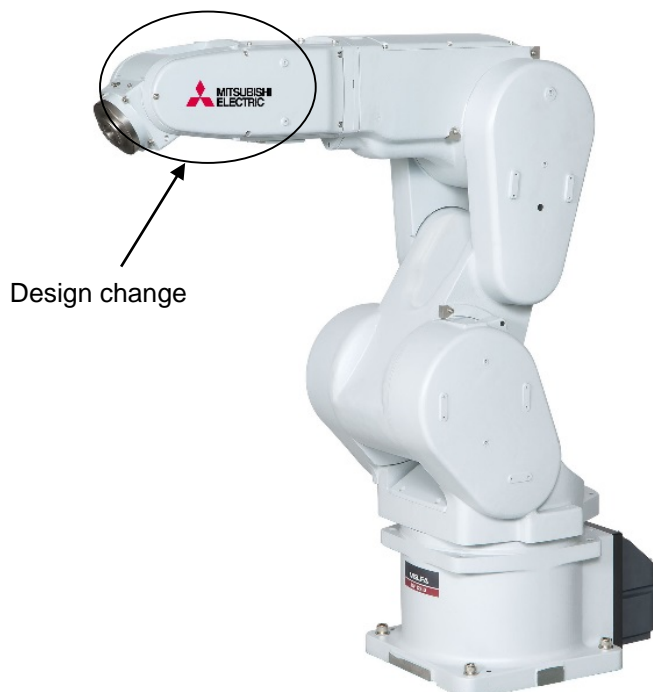
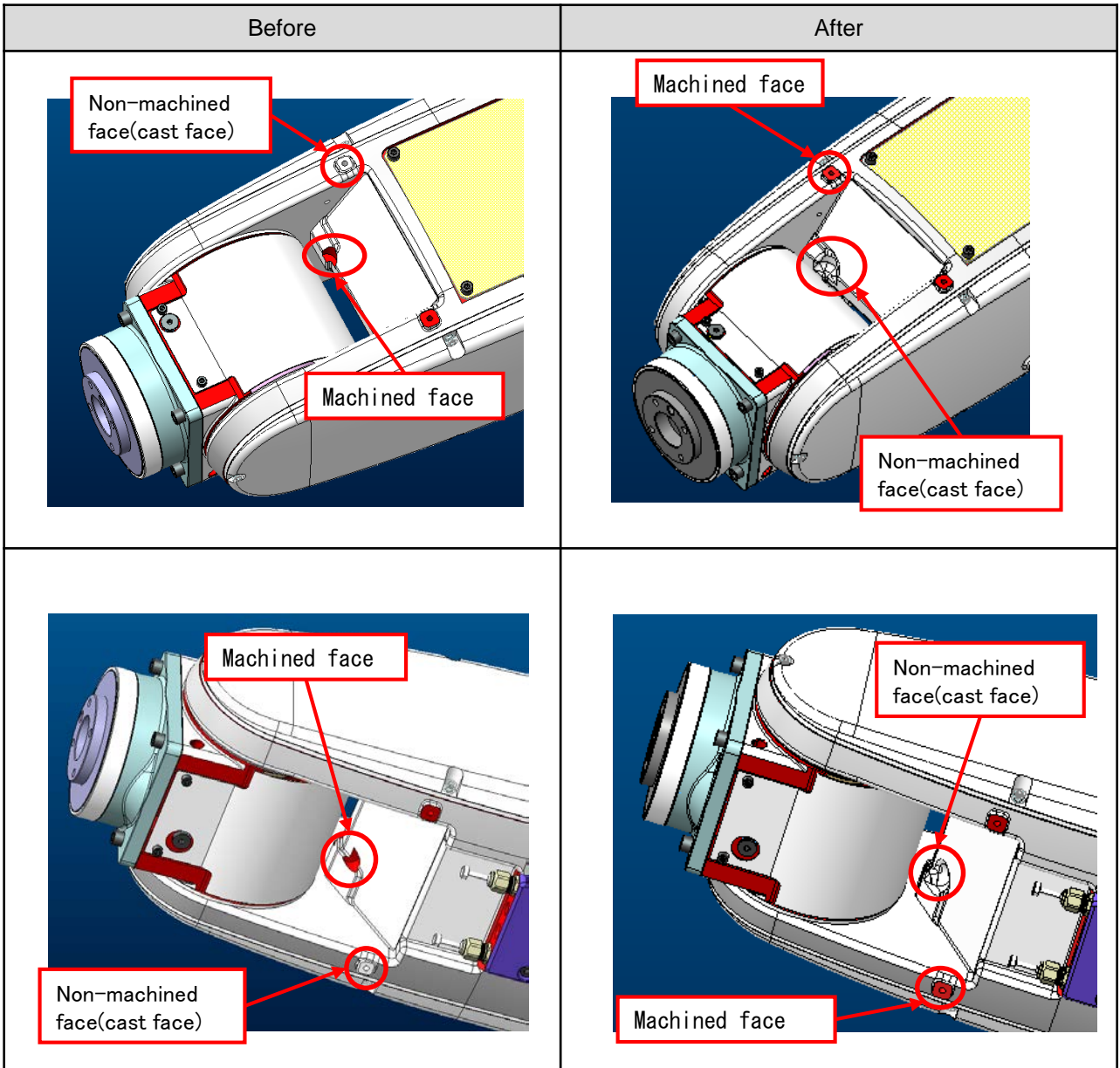

Figure 1 Details of the design change



**3. Reason for change**

For productivity improvement.

**4. Schedule**

Change before and after products will be mixed from April 2017.